

issued for:  
 OWNER REVIEW: 22 OCT. 18  
 OWNER REVIEW: 11 DEC. 18  
 OWNER REVIEW: 21 DEC. 18  
 OWNER REVIEW: 03 JAN. 19  
 OWNER REVIEW: 07 JAN. 19  
 OWNER REVIEW: 11 JAN. 19  
 OWNER REVIEW: 22 JAN. 19  
 OWNER REVIEW: 24 JAN. 19  
 OWNER REVIEW: 25 JAN. 19  
 OWNER REVIEW: 15 FEB. 19  
 OWNER REVIEW: 22 FEB. 19  
 OWNER REVIEW: 26 FEB. 19  
 OWNER REVIEW: 28 FEB. 19  
 OWNER REVIEW: 04 MAR. 19

project:

Renovation For Existing  
**Commercial Development**  
 Saginaw Rd. & Holly Rd.  
 Grand Blanc, Michigan



32500 TELEGRAPH ROAD  
 SUITE 250  
 BINGHAM FARMS, MICHIGAN  
 48025-2404  
 PH 248.540.7700 FX 248.540.2710  
 www.rogvoy.com

drawing:  
**Conceptual Site Plan**

DO NOT SCALE DRAWING  
 issue date: 22 OCT. 18  
 drawn: KL  
 checked: MD  
 approved: MD

file number: 14025-D  
 sheet:

**SP-1**

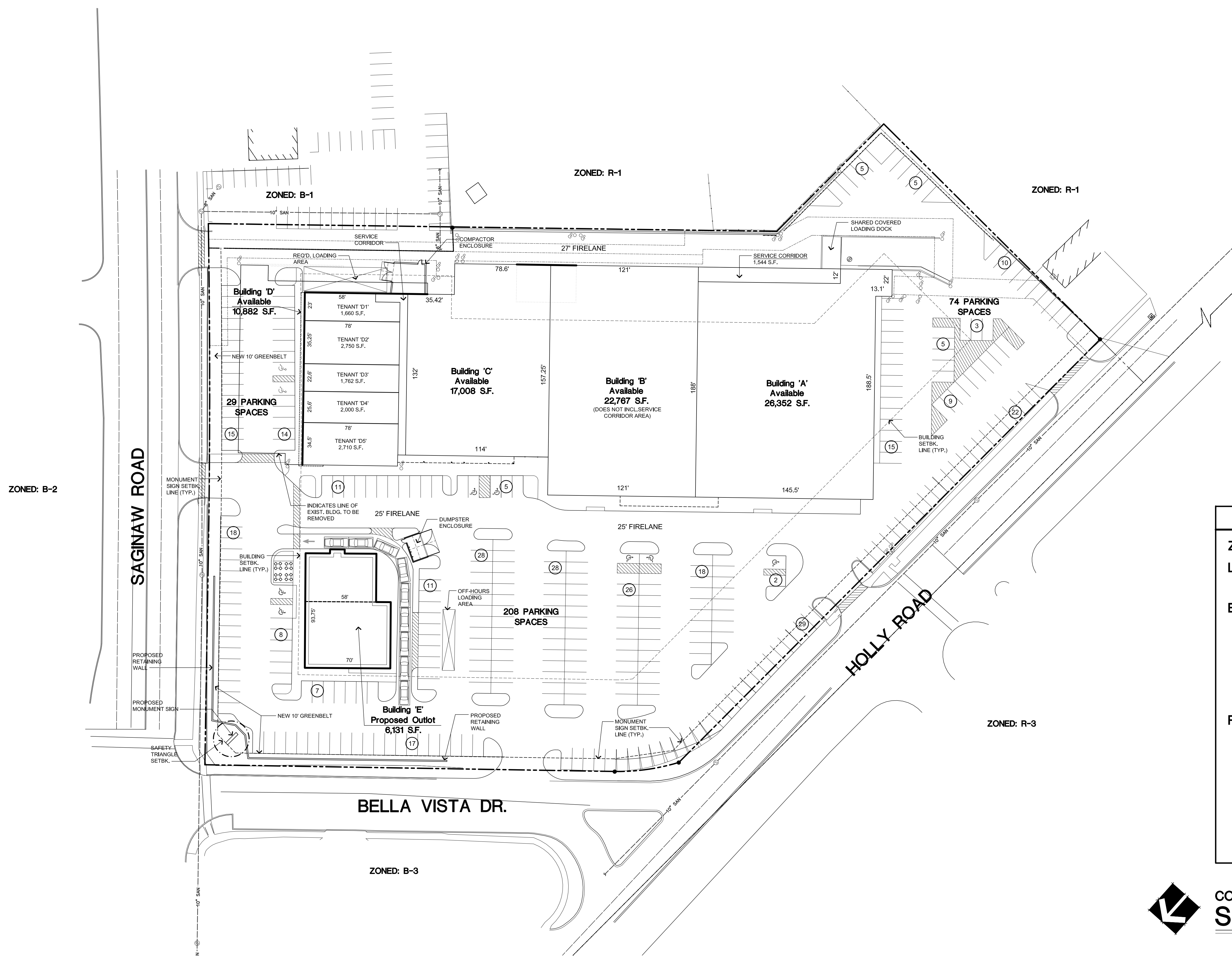

LAND/ BUILDING/ PARKING DATA :	
<b>ZONING : B-2</b>	
<b>LAND DATA :</b>	
LAND AREA :	± 6.0 ACRES
<b>BUILDING DATA :</b>	
BUILDING 'A'	26,352 S.F.
BUILDING 'B'	22,767 S.F.
BUILDING 'C'	17,668 S.F.
BUILDING 'D'	10,882 S.F.
BUILDING 'E'	6,131 S.F.
TOTAL BUILDING AREA :	83,800 S.F.
<b>PARKING DATA :</b>	
TOTAL PARKING REQUIRED :	335 SPACES <small>1 SPACE / 250 G.L.A. = (83,800 / 250) = 335</small>
TOTAL PARKING PROPOSED :	311 SPACES <small>(3.7 SPACES/ 1,000 S.F. GROSS)</small>
STACKING SPACES REQUIRED :	10 SPACES <small>(9'x25')</small>
STACKING SPACES PROVIDED :	9 SPACES <small>(9'x20')</small>

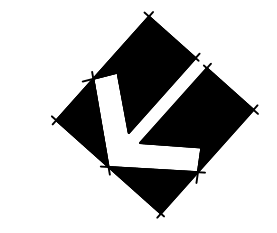

**CONCEPTUAL SITE PLAN**

SCALE: 1"=40'-0"